



Wheatfield Road

Harpenden, AL5 2NY

A very well presented and extremely spacious Jarvis built detached bungalow with a mature private garden, 90 ft at its longest. Located in West Common, one of Harpenden's premier residential areas, within a short drive of Harpenden town centre and station.

Guide price £1,595,000

Wheatfield Road

Harpenden, AL5 2NY



- Spacious single level living
- Generous room proportions
- Peaceful prime West Common location
- Circa 2,350 sq ft
- Detached garage
- Short drive to Harpenden town centre and station
- Jarvis built
- Mature private garden
- Council Tax Band G

Porch

Entrance Hall

Cloakroom

Living Room

25'1" x 15'2" (7.67m x 4.63m)

Kitchen/Breakfast Room

22'1" x 11'0" (6.75m x 3.37m)

Utility

7'3" x 7'3" (2.23m x 2.21m)

Dining Room

18'3" x 15'1" (5.57m x 4.61m)

Bedroom One

17'1" x 14'2" (5.22m x 4.33m)

Dressing Area

10'5" x 8'9" (3.18m x 2.67m)

En-suite Bath and Shower Room

Bedroom Two

16'3" max x 11'8" (4.97m max x 3.57m)

Bedroom Three

16'5" max x 11'8" (5.01m max x 3.57m)

Bathroom

Garage

18'10" x 15'10" (5.75m x 4.85m)





Floor Plan

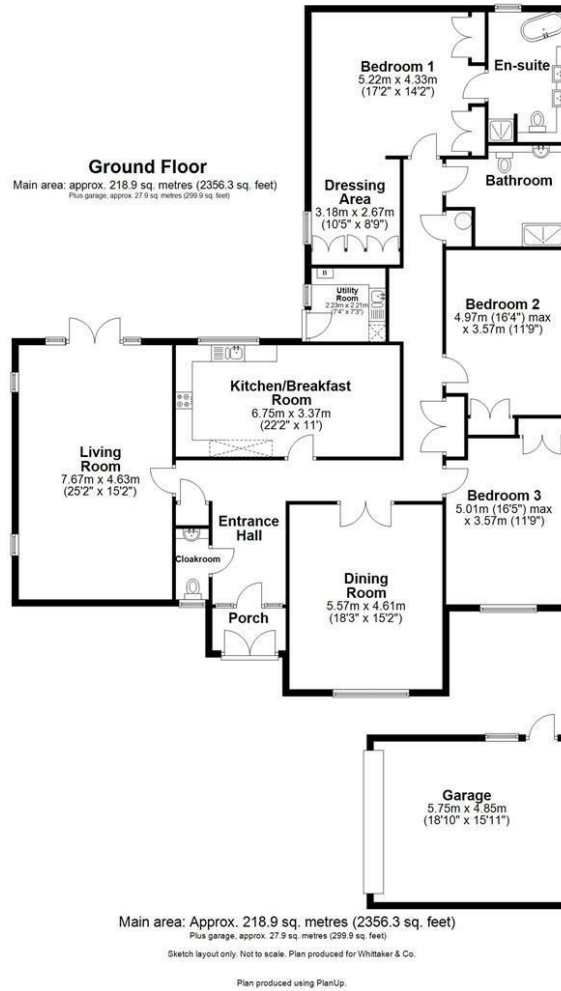

These particulars, whilst believed to be accurate are set out as a general outline only for guidance and do not constitute any part of an offer or contract. Intending purchasers should not rely on them as statements of representation of fact, but must satisfy themselves by inspection or otherwise as to their accuracy. No person in this firm's employment has the authority to make or give any representation or warranty in respect of the property.

